

# Help us design Bissell 307

A group of students at the Faculty of Information are working to transform Rm 307 into a studio workspace (like a makerspace, but please don't let that term constrain your ideas).

We need your help getting started:

1. Take a few minutes to think about what you could do in a space like this and how you could use it.
2. Draw and write your ideas here. You can include tools, people, equipment, communities, concepts, a cup of tea...
3. Hand your sheet back to me, OR drop it in mailbox A20 (Dan S.), OR email it to [jess.whyte@gmail.com](mailto:jess.whyte@gmail.com), OR bring it to our first design session (May 19, 10-12 in Rm 307).

Your turn: I think what is important for this space is to have lots of work space that is flexible.

One of the work benches could be dedicated to sewing machines (yes please!) while another could be stocked with tools. There would be lots of chairs that could be moved around

The room off to the side could be

Several things: reservable meeting area, reservable private maker area, or it could house something like a 3D printer.

\_\_\_\_\_  
\_\_\_\_\_  
\_\_\_\_\_

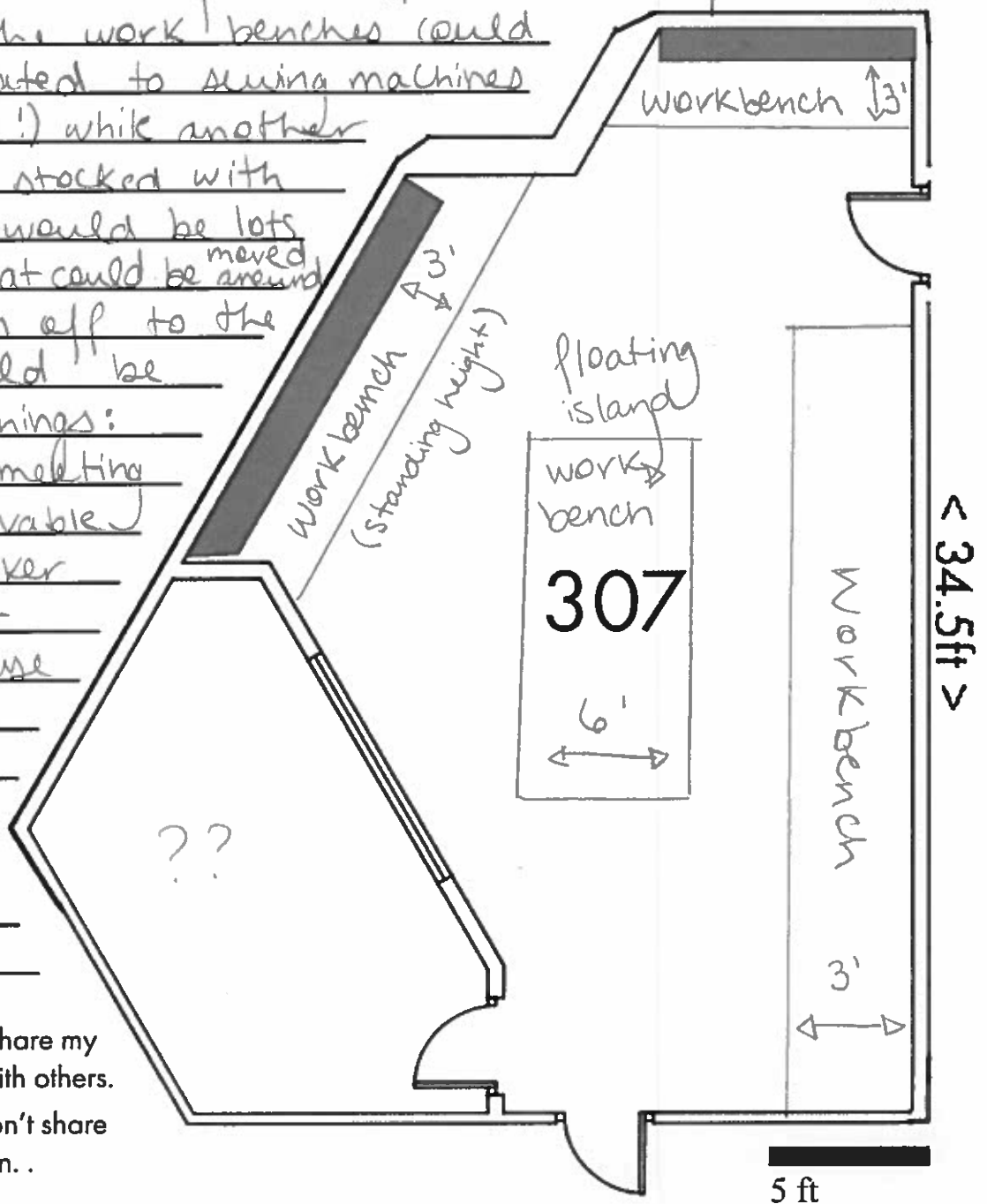

- Yes, you can share my contribution with others.
- No, please don't share my contribution.